

All Floors - Renaissance Phoenix Downtown Hotel

FIFTH FLOOR (Outdoor)

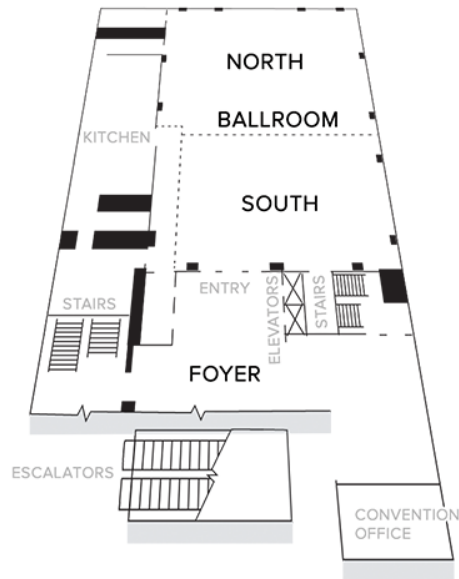

BALLROOM LEVEL



LOBBY LEVEL

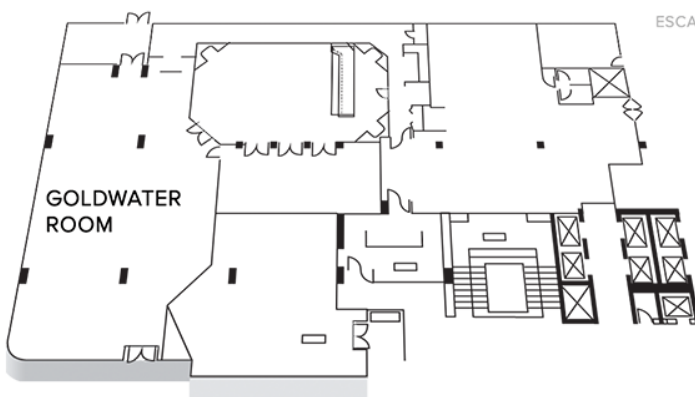

SALON LEVEL

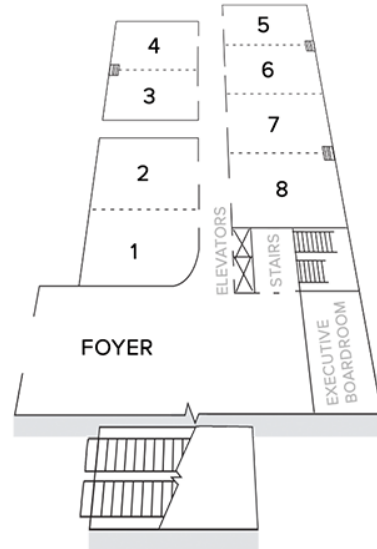

LOWER LEVEL

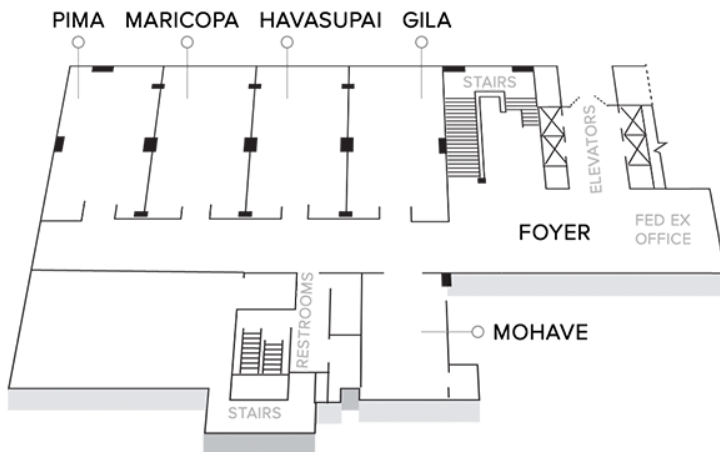

STREET LEVEL

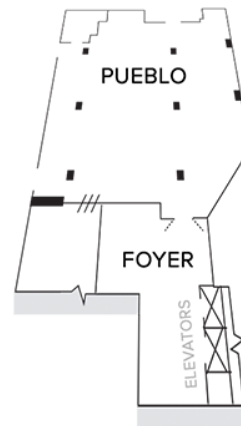

All Floors - Renaissance Phoenix Downtown Hotel

	DIMENSIONS L X W X H	SQ FT	BANQUET ROUNDS OF 10	RECEPTION	THEATER	CLASSROOM	HOLLOW SQUARE	U-SHAPE	EXHIBITS 8 X 10s
GUEST ROOM TOWER									
FIFTH FLOOR									
Skyline (Outdoor)	182'x55'	10,000	400	500	-	-	-	-	-
LOBBY LEVEL									
Goldwater Room	34'x42'x10'	2,300	140	175	200	100	34	30	-
LOWER LEVEL									
Gila	43'x25'x11'	1,075	80	111	118	55	31	26	-
Havasupai	43'x25'x11'	1,075	80	111	118	55	31	26	-
Maricopa	43'x25'x11'	1,075	80	111	118	55	31	26	-
Pima	43'x25'x11'	1,075	80	111	118	55	31	26	-
Mohave Conference for 16	17'x29'x11'	-	-	-	-	-	-	-	-
Lower Level Foyer	147'x16'x11'	2,320	-	-	-	-	-	-	-
CONFERENCE CENTER									
BALLROOM LEVEL									
Grand Ballroom	118'x87'x15'	10,266	770	950	950	690	-	-	62
North Ballroom	68'x87'x15'	5,916	430	550	550	360	-	-	34
South Ballroom	53'x87'x15'	4,611	330	400	400	279	-	-	25
Ballroom Level Foyer	91'x31'	2,821	-	-	-	-	-	-	-
SALON LEVEL									
Salon 1-2	63'x29'x13'	2,038	140	200	200	130	60	50	-
Salon 1	29'x29'x13'	850	50	49	49	40	16	20	-
Salon 2	36'x33'x13'	1,188	90	115	125	75	33	28	-
Salon 3-4	50'x36'x13'	1,800	140	180	200	123	51	43	-
Salon 3	25'x36'x13'	900	70	90	100	60	26	20	-
Salon 4	25'x36'x13'	900	70	90	100	60	26	20	-
Salon 5-8	110'x38'x13'	4,180	320	400	420	250	-	-	25
Salon 5, 6, 7	38'x25'x13'	950	70	95	105	66	27	23	-
Salon 8	38'x33'x13'	1,254	100	125	125	80	36	30	-
Executive Boardroom Conference for 12	22'x14'x13'	-	-	-	-	-	-	-	-
Salon Level Foyer	86'x31'x13'	2,666	-	-	-	-	-	-	-
STREET LEVEL									
Pueblo	91'x91'x11'	8,281	600	850	750	350	-	-	40